

PLEASE READ THESE INSTRUCTIONS BEFORE COMMENCING INSTALLATION & LEAVE WITH END USER

Description:

The FRO/6 bulkhead is a robust IP65 luminaire which offer 950 lumen in mains operation and 650 lumen in emergency operation. The high emergency output provided by this product in emergency makes it ideal for higher ceilings.

The FRO/6 is manufactured with an opal ribbed lumaxx diffuser which offers a high light output ratio (LOR). Ldt files in both mains and emergency operation are available, please contact the Liteplan sales office who will be happy to send them to you.

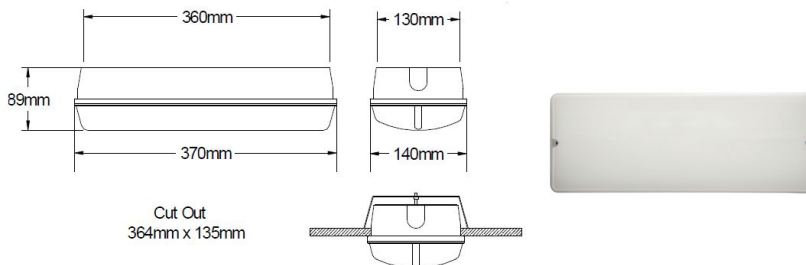

Specification:

Input Voltage	230-240 Volts AC 50/60 Hz
Power Rating Maintained	14.8W 103mA - $\lambda = 0.6$
Power Rating Non-Maintained	5W 23mA $\lambda = 0.88$
Ambient Temp.	0°C to + 25°C
Mains Input Terminal	0.5mm - 2.5mm
Battery Fuse	Internal to NED/6 or NDA/6
Battery Discharge Current	1000mA
Discharge Voltage Cut Off	6.0V
Ingress Protection	IP65
Battery Pack	7.2V 4.5Ah NiCd
Charge Current	200mA \pm 25mA
Recharge Period	24 Hours
Width and Length	370mm 140mm
Depth	89mm
Side Cable Entry	20mm Knock Outs L&R
Rear Cable Entry	20mm Knock Out Centre
Overall Weight (maintained)	3.8Kg

Product codes

FRO/6/NM3	Non-maintained 3 hour
FRO/6/M3	Maintained 3 hour
FRO/6/DA	Non-maintained 3 hour DALI self-test

Important

It is recommended that this product is installed by a competent person in accordance with the current building and wiring regulations.. Liteplan accept no responsibility for injury, damage or loss, which may arise as a result of incorrect installation, operation or maintenance.

The product requires an un-switched supply for charging the battery and a switched supply for maintained operation.

ISOLATE MAINS SUPPLIES AND DISCONNECT THE BATTERY BEFORE INSTALLATION OR MAINTENANCE.

Installation:

1. Remove the two front screws and lift off diffuser.
2. Remove the two screws on the hinged geartray and lift to reveal the components underneath.
3. Open your desired cable entry and feed mains cable through. Use the required IP rated gland to ensure that IP rating is maintained.
4. Connect the cables to the terminal block as shown in the diagram overleaf.
5. For Non-Maintained operation, do not connect to the Switched Live terminal.
6. Connect the battery.
7. Screw the geartray back into position ensuring no cables are trapped.
7. Refit the cover.
8. Fit the screws back into the diffiser making a water tight seal.

PLEASE READ THESE INSTRUCTIONS BEFORE COMMENCING INSTALLATION & LEAVE WITH END USER

Typical Wiring Diagram

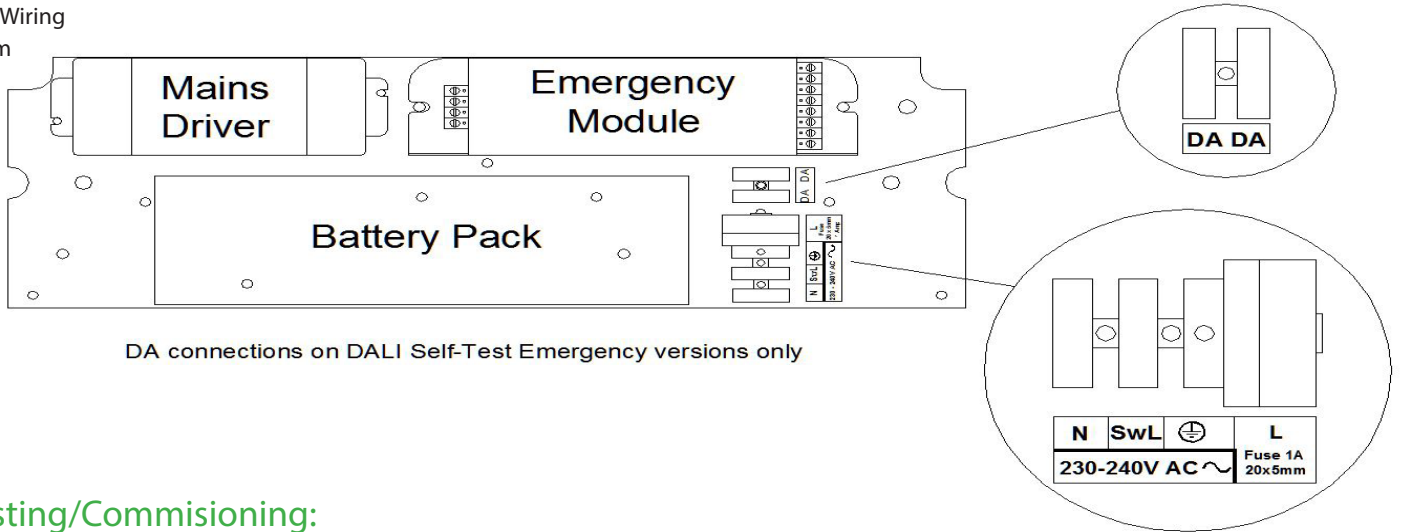

Testing/Commissioning:

- Ensure the power is connected.
- Connect the battery.
- Switch on the Un-switched Supply - Check the Charge LED illuminates.
- Switch off the Un-switched Supply - Check the Charge LED extinguishes and the load LED illuminates.
- Enter the commissioning date on the Battery Pack.
- Switch on the Un-switched Supply

Luminaire Ref/Location			In case of difficulty, contact the Installation Engineers:- Tel:							
Full Recharge Time 24 Hours			Duration 3 Hours				Lamp Type - LED			
ROUTINE TEST RECORD										
	Year 1		Year 2		Year 3		Year 4		Year 5	
	Signed	Date	Signed	Date	Signed	Date	Signed	Date	Signed	Date
Monthly Test										
Functional										
Functional										
Functional										
Functional										
Functional										
Functional										
Functional										
Functional										
Functional										
Functional										
Three Hour										